

REVISIONS					
REV	ECO	DESCRIPTION	DATE	BY	APPR
A1		NEW RELEASE	21AUG14	JARRY	

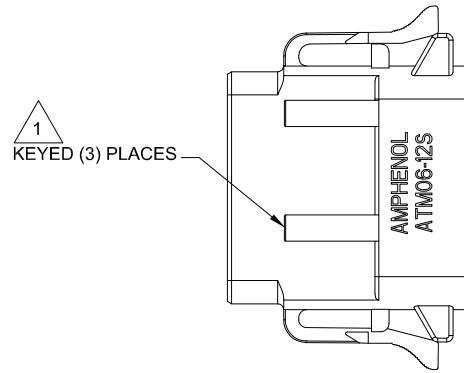

REQUIRES CONTACT RETENTION WEDGE AWM-12S

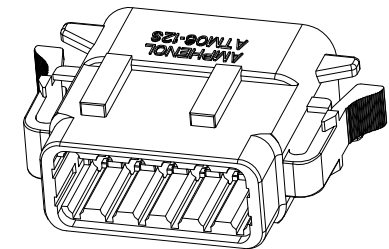
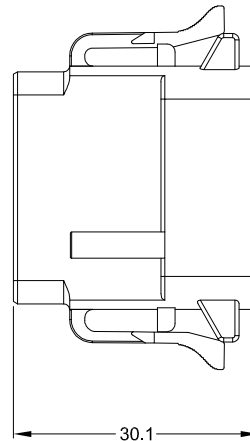
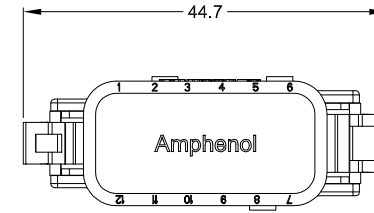
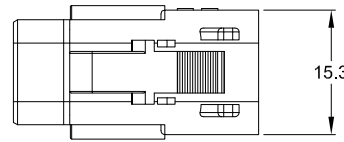
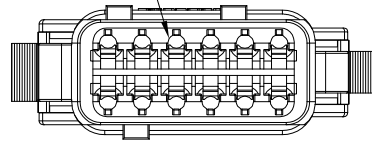

NOTES: UNLESS OTHERWISE SPECIFIED

1 SEE SHEET 2 FOR KEY ARRANGEMENTS AND COLORS.

2. MATERIAL:

HOUSING: THERMOPLASTIC  
SEAL: SILICONE RUBBER

3. MODIFICATIONS: SOLID SEAL

4. SPECIFICATIONS:

- 4.1 CURRENT RATING: 7.5 AMPS
- 4.2 OPERATING TEMPERATURE: -55°C TO +125°C
- 4.3 DIELECTRIC WITHSTANDING VOLTAGE: LESS THAN 2 MILLIAMPS CURRENT LEAKAGE @ 1500 VOLTS AC.
- 4.4 INSULATION RESISTANCE: 1000 MEGOHMS MIN @ 25°C.
- 4.5 MOISTURE RESISTANCE: IP67 ( MATED CONDITION )
- 4.6 MATING CYCLE DURABILITY: 100 CYCLES
- 4.7 RoHS COMPLIANT

5. MATING PART: ATM04-12PX\* RECEPTACLE.  
( X = A,B,C,D KEYS; \* = MODIFICATIONS AND COLORS )

6. ALL DIMENSIONS ARE FOR REFERENCE USE ONLY.

TITLE: PLUG, KEYED, 12 SOCKET SOLID SEAL ATM SERIES  
DWG NO.: ATM06-12SX-SSXX  
REV: A1  
SH: 1  
OF: 2

SEE SHEET 2		DESCRIPTION		ITEM
QUANTITY	PART NUMBER	MATERIALS LIST		
UNLESS OTHERWISE SPECIFIED 1) All dimensions are in metric (mm). 2) Tolerances are as follows: 1 PL DEC ±0.30 2 PL DEC ±0.15 3 PL DEC ±0.08		SIGNATURES DRAWN: JARRY CHECKED: ENGINEER: APPROVAL:		DATE 21AUG14
MATERIAL SPECIFICATIONS:		CUSTOMER:		<b>Amphenol</b> Sine Systems - www.amphenol-sine.com 44724 Morley Drive Clinton Township, MI 48036
PROCESS SPECIFICATIONS:		THIS DRAWING IS SUPPLIED FOR INFORMATION ONLY. DESIGN FEATURES, SPECIFICATIONS AND PERFORMANCE DATA SHOWN HEREON ARE THE PROPERTY OF THE AMPHENOL CORPORATION. NO RIGHTS OF REPRODUCTION ARE IMPLIED. ALL DIMENSIONS ARE SUBJECT TO NORMAL MANUFACTURING VARIATIONS.		
NEXT ASSY:		SIZE B C-	TYPE ATM06-12SX-SSXX	REVISION A1
		SCALE NONE	SHEET 1 OF 2	

REVISIONS					
REV	ECO	DESCRIPTION	DATE	BY	APPR

P/N ATM06-12SA-SS01  
KEY-A CONFIGURATION  
STANDARD COLOR: GREY

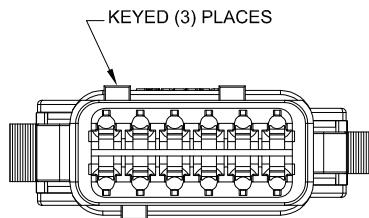
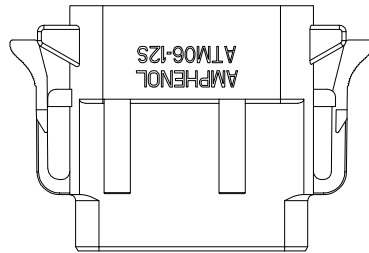

KEY-A CONFIGURATION	
COLOR	PART NUMBER
<b>* GREY</b>	<b>ATM06-12SA-SS01</b>
BLACK	ATM06-12SA-SSBLK
GREEN	ATM06-12SA-SSGEN
BROWN	ATM06-12SA-SSBRN

P/N ATM06-12SB-SS01  
KEY-B CONFIGURATION  
STANDARD COLOR: BLACK

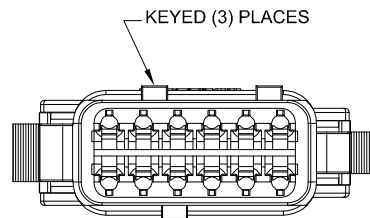
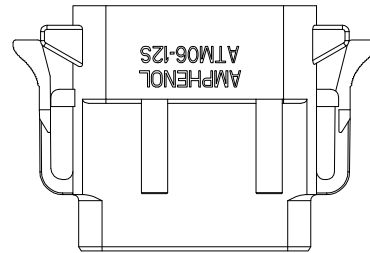

KEY-B CONFIGURATION	
COLOR	PART NUMBER
GREY	ATM06-12SB-SSGRY
<b>* BLACK</b>	<b>ATM06-12SB-SS01</b>
GREEN	ATM06-12SB-SSGRN
BROWN	ATM06-12SB-SSBRN

P/N ATM06-12SC-SS01  
KEY-C CONFIGURATION  
STANDARD COLOR: GREEN

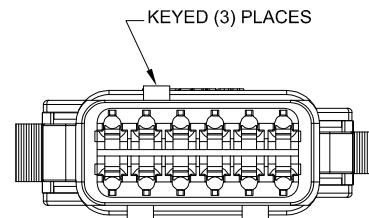
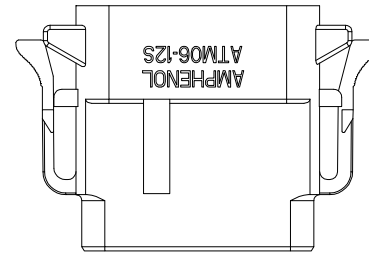

KEY-C CONFIGURATION	
COLOR	PART NUMBER
GREY	ATM06-12SC-SSGRY
BLACK	ATM06-12SC-SSBLK
<b>* GREEN</b>	<b>ATM06-12SC-SS01</b>
BROWN	ATM06-12SC-SSBRN

P/N ATM06-12SD-SS01  
KEY-D CONFIGURATION  
STANDARD COLOR: BROWN

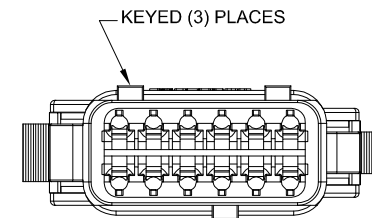
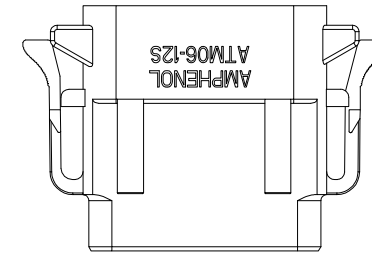

KEY-D CONFIGURATION	
COLOR	PART NUMBER
GREY	ATM06-12SD-SSGRY
BLACK	ATM06-12SD-SSBLK
GREEN	ATM06-12SD-SSGRN
<b>* BROWN</b>	<b>ATM06-12SD-SS01</b>

**NOTE:**

AN ASTERISKS ( \* ) PLACED BEFORE THE COLOR DENOTES THE STANDARD MOLDED COLOR OF THE CONNECTORS SHOWN ABOVE.

OTHER COLORS SHOWN ARE AVAILABLE VIA SPECIAL ORDER.

TITLE: PLUG, KEYED, 12 SOCKET SOLID SEAL ATM SERIES  
DWG NO.: ATM06-12SX-SSXX  
REV: A1  
SH: 2  
OF: 2

QUANTITY	PART NUMBER	DESCRIPTION	ITEM												
<b>MATERIALS LIST</b>															
UNLESS OTHERWISE SPECIFIED 1) All dimensions are in metric (mm). 2) Tolerances are as follows: 1 PL DEC ±0.30 2 PL DEC ±0.15 3 PL DEC ±0.08 3) Note reference =		<table border="1"> <thead> <tr> <th>SIGNATURES</th> <th>DATE</th> </tr> </thead> <tbody> <tr> <td>DRAWN: JARRY</td> <td>21AUG14</td> </tr> <tr> <td>CHECKED:</td> <td></td> </tr> <tr> <td>ENGINEER:</td> <td></td> </tr> <tr> <td>APPROVAL:</td> <td></td> </tr> <tr> <td>CUSTOMER:</td> <td></td> </tr> </tbody> </table> <p style="text-align: center;"><b>Amphenol</b> Sine Systems - www.amphenol-sine.com 44724 Morley Drive Clinton Township, MI 48036</p> <p style="text-align: center;"><b>PLUG, KEYED, 12 SOCKET SOLID SEAL, ATM SERIES</b></p>		SIGNATURES	DATE	DRAWN: JARRY	21AUG14	CHECKED:		ENGINEER:		APPROVAL:		CUSTOMER:	
SIGNATURES	DATE														
DRAWN: JARRY	21AUG14														
CHECKED:															
ENGINEER:															
APPROVAL:															
CUSTOMER:															
MATERIAL SPECIFICATIONS:		THIS DRAWING IS SUPPLIED FOR INFORMATION ONLY. DESIGN FEATURES, SPECIFICATIONS AND PERFORMANCE DATA SHOWN HEREON ARE THE PROPERTY OF THE AMPHENOL CORPORATION. NO RIGHTS OF REPRODUCTION ARE IMPLIED. ALL DIMENSIONS ARE SUBJECT TO NORMAL MANUFACTURING VARIATIONS.													
PROCESS SPECIFICATIONS:		SIZE: <b>B C-</b>	REVISION: <b>A1</b>												
NEXT ASSY:		SCALE: <b>NONE</b>	SHEET <b>2</b> OF <b>2</b>												